

KORA 25W LED

SWITCH 2.700K 3.000K 4.000K

INSTRUCTIONS FOR USE

(to be carefully stored for further consultation)

Read these warnings carefully before installing the ceiling.

1. Remove the apparatus from the packaging and check its integrity. In case of doubt do not proceed to the assembly and contact your reseller.
 2. Do not install the device in an environment without adequate ventilation.
 3. Before the electrical connection it is necessary to check that the data of the power supply network correspond to those specified in this manual.
 4. The electrical connection shall be made by qualified personnel. Before making the electrical connection, make sure you have removed voltage from the grid.
 5. Do not misuse the device (different use for which it was designed). The manufacturer may not be held liable for damage resulting from improper, erroneous and unreasonable uses.
 6. Do not install the device in environments with dangerous atmospheres.
 7. Installation shall be carried out as instructed by the manufacturer; incorrect installation may cause damage to persons, animals or things for which the manufacturer cannot be held liable.
 8. Do not allow the device to be used by children or disabled persons without supervision.
 9. Cleaning is restricted to the external surface of the appliance.
- NOTE: DO NOT use DETERGENTS, DETERMINATIONS, WINDOW DETERMINATIONS, PLASTICS AND THE like. Use only a soft, slightly moist pan.
10. In case of malfunction, do not tamper with the device. For repair, please contact qualified personnel.
 11. Do not attach the device to a fragile wall or in bad condition.

PART OR SUBSTANCE INSTALLATION

1. Remove the staff by pressing inwards and simultaneously the two buttons placed at the ends of the ceiling (Fig. 1a and 1b). The staff will detach automatically.
2. Attach the bar to the wall using the two tiles (fig.2).
3. Make electrical connections respecting the voltage and frequency indicated on the plate data and respecting the specified L -N polarity). Make sure that no conductor has exposed copper fragments.

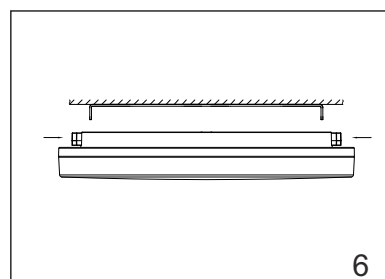
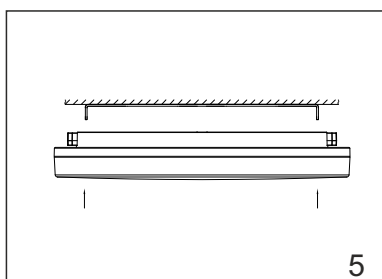
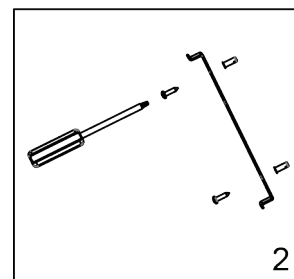
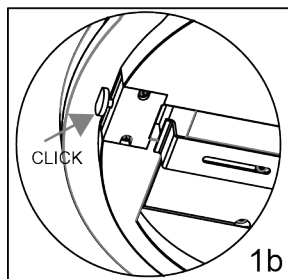
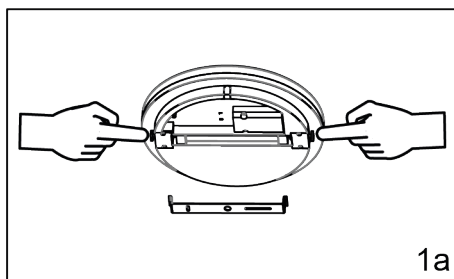

4. Select the desired colour temperature.

5. Mount the ceiling on the stand with a slight but firm pressure. The ceiling will automatically hook up.

6. In case it is necessary to remove the cap from the stand: press inwards and simultaneously the 2-button positions at the end of the cap until the detachment takes place.

SWITCH 2.700K 3.000K 4.000K

3.000 lm

50Hz
0,18A
Pf: 0,9



IP54



PC +PC

120lm/w



+45°C
-25°C

RoHS

